

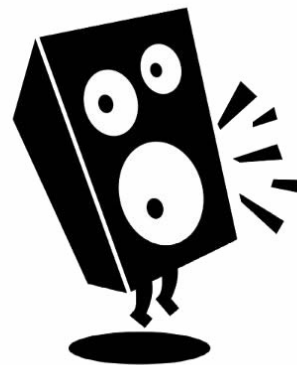

M4S Crossover

the **loud**
speaker
kit



Woofer: SB12PFC25-8
 Tweeter: SB19ST-C000-4
 Crossover: 4.0KHz
 High Pass: 18dB/Octave
 Low Pass: 12dB/Octave

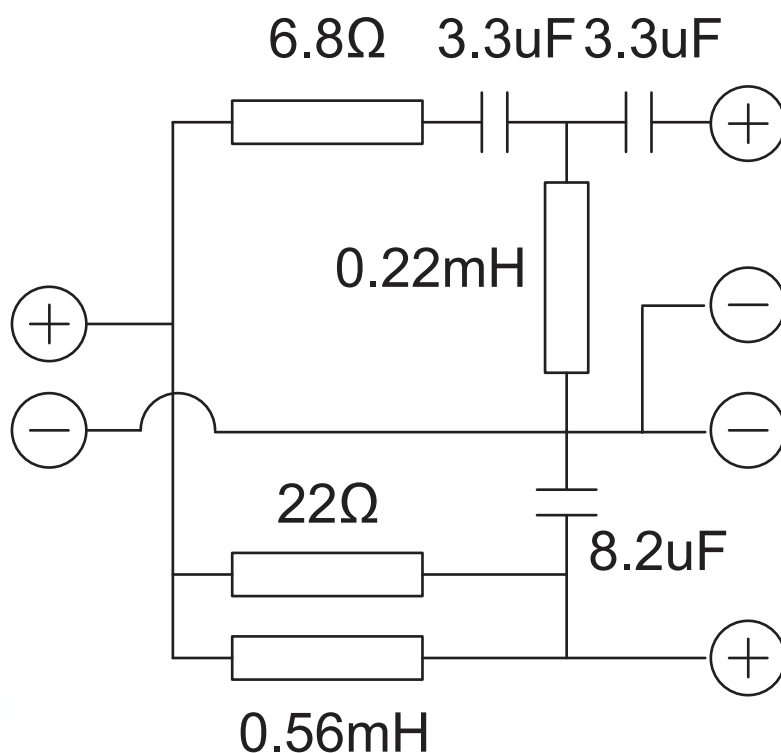
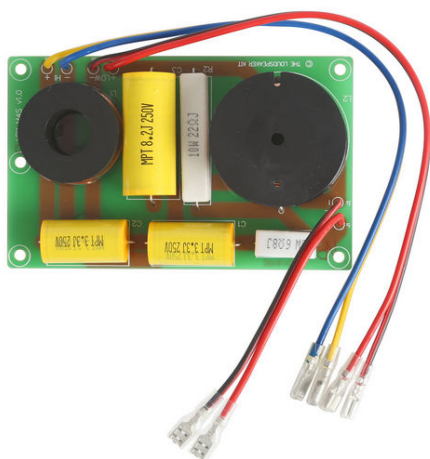

XO-M4S (4KHz)

SPK140



the loud speaker kit

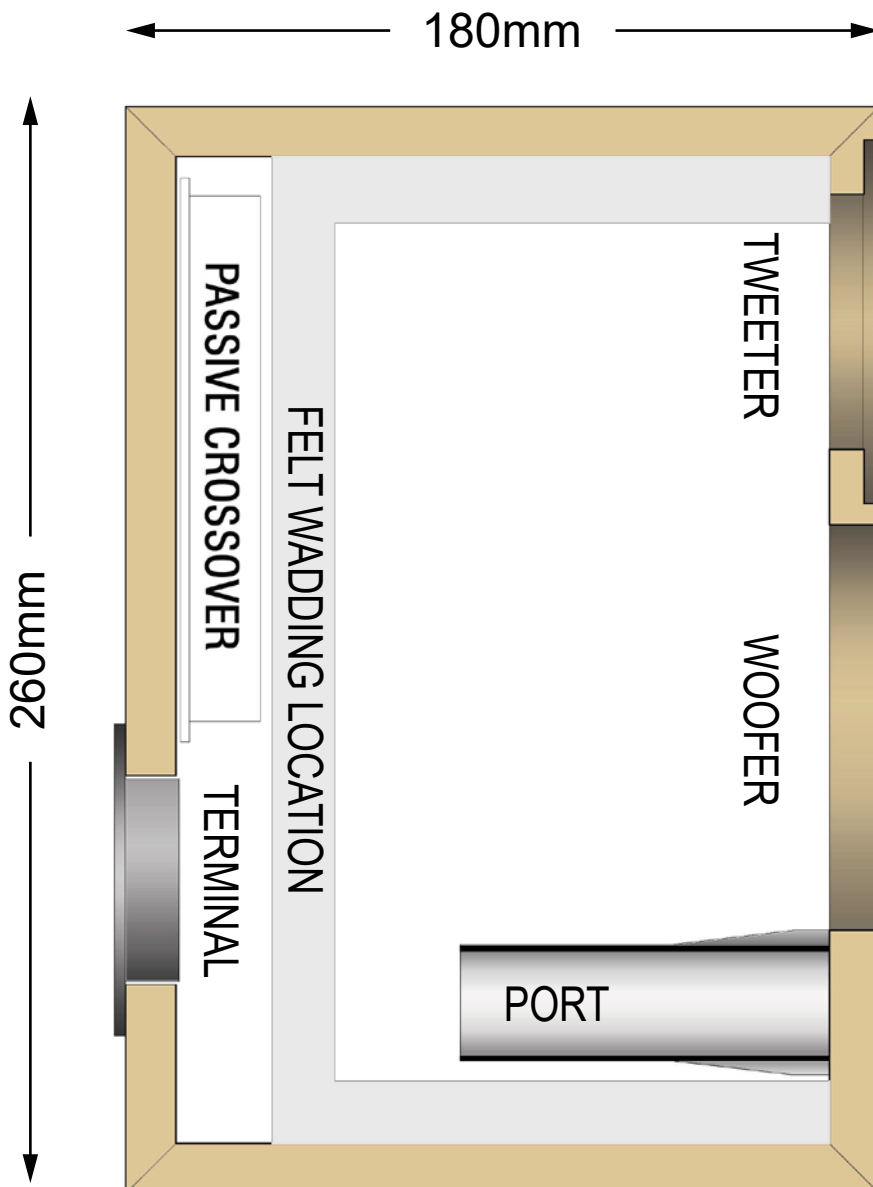
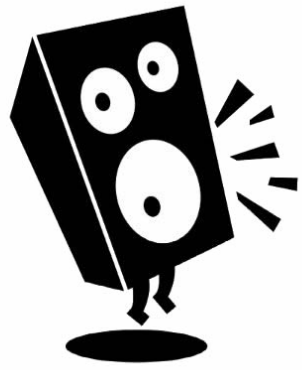

M4S CABINET

12mm MDF

Height: 260mm

Width: 120mm

Depth: 180mm

Port: 100x25mmØ



PORT1X4L

Hole: 35mmØ

Tuned for

Woofer:

SB12PFC25-8

FRONT

120mm Wide

12mm MDF



M4S Assembly Instructions

YouTube



See our YouTube Channel to view our online assembly guide
<http://www.youtube.com/c/TheLoudspeakerKit>

Suits: (Kit Includes)
SB Acoustics
SB19ST-C000-4 3/4" Tweeter
SB12PFC25-8 4.5" Mid-Woofer
XO-M4S Crossover Assembled
J709 Speaker Terminals
PORT1X4L 25mm Port



Designed and manufactured in Australia by The Loudspeaker Kit
www.theloudspeakerkit.com

Email: sales@theloudspeakerkit.com



You will need:

- Phillips head screwdriver
- Woodworking glue
- Damp cloth
- Good quality masking tape
- Ratchet tie down strap (optional)
- Brick or other weight (optional)

Preparation

Lay the contents of the box out and check you have everything you need to complete the kit (see parts list on back page). Find a suitable work surface and make sure it won't be ruined if you spill some glue. If covering the work surface, avoid using newspaper as newsprint may rub off onto your kit. Baking paper is a good choice.

Easier assembly with mitres

LSK kits now employ mitre construction, which offers greater ease of assembly with much less sanding. Butt joints are eliminated, avoiding visible hairline cracks that often appear after painting. Mitre construction puts the joint right on the edge where it is less visible. Most constructors avoid using mitres due to the difficulty in getting the angles correct. Our manufacturing process provides a level of accuracy that is very difficult to achieve in a home workshop.

Masking tape

We recommend avoiding cheap masking tape, which tends to break when applied under tension. If you aren't using the weight and ratchet strap, you are relying on the masking tape along to apply pressure to the join as the glue sets.

Lay out the rear, side, top and bottom panels as shown with mitres facing the work surface. Align carefully and arrange so that all panels are touching at the edges, with no gaps.



Tape all four joints where the rear panel meets the side and top panels. It's a good idea to avoid covering the corners so that you can ensure all panels remain aligned during taping.

Lift the panels using the hole for the terminals, turning them over to the other.





Tip: placing masking tape as shown assists with folding up the panels.

Apply a bead of wood working glue to the bottom of the mitre joint. Then apply a second bead. Since the glue will tend to run down towards the bottom, it's a good idea to apply the glue above half way up to ensure even coverage.



Confirm the amount of glue applied by folding up the first panel. The glue should cover the entire surface in contact. It's preferable to see the glue ooze beyond the joint slightly. This provides visual feedback on whether the glue has set. Once set, PVA glue becomes transparent.



Apply a single thick bead for the top and side panels. Test the first pair of mitres to confirm glue coverage, then glue and fold up all the other panels. It is best to fold up and then tape one join at a time. Ensure the glue covers the joint before moving on to the next step.

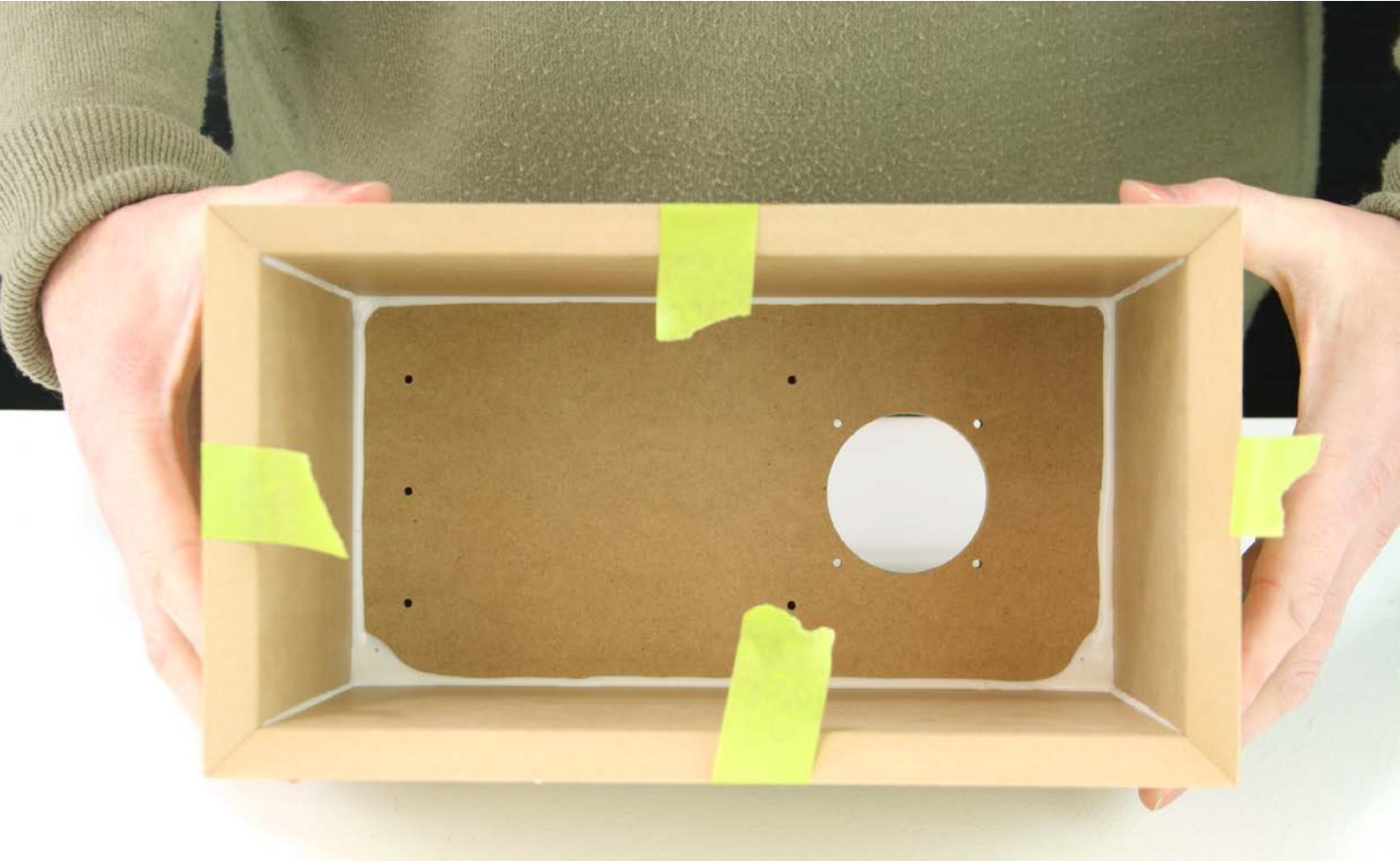

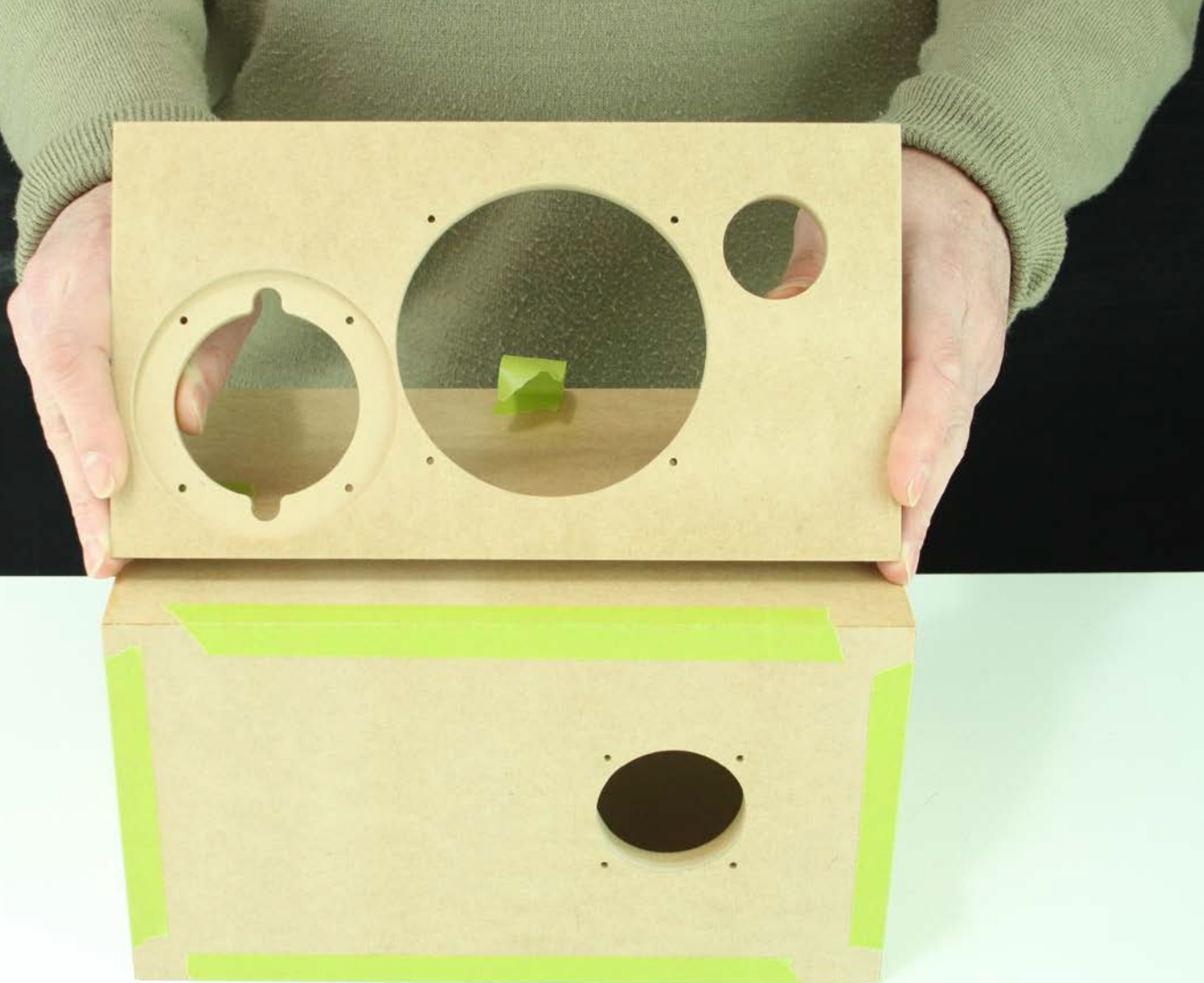

Ensure the front baffle has the correct orientation. The port on the front and terminals on the back should be oriented so they are both on the bottom. In the picture above they are both on the right as the speaker is placed on its side.

Apply a thick glue bead around the internal surfaces of the mitres. You may prefer a zig zag pattern with a thinner bead. It's a good idea to remove the panel and confirm even coverage.





Once you have confirmed adequate glue coverage, press the baffle into place and wipe off all excess glue with a damp cloth. Secure panels firmly with masking tape. Apply pressure when pressing the tape into position. The tape holds the panels together as the glue sets.

Cover all joints with tape, as shown below. An optional step for improved clamping pressure is securing top, bottom and side panels together with a tie down ratchet strap. Avoid damage to the surface of the MDF by placing cardboard strips under the straps at all four corners. Be careful to avoid applying too much force, which can damage the corners of the MDF.

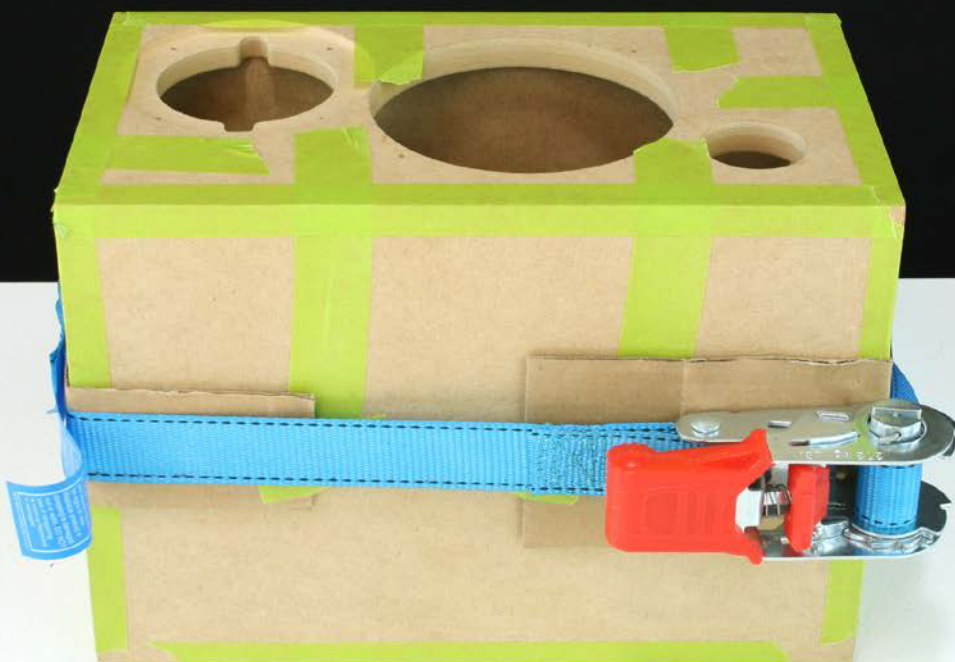

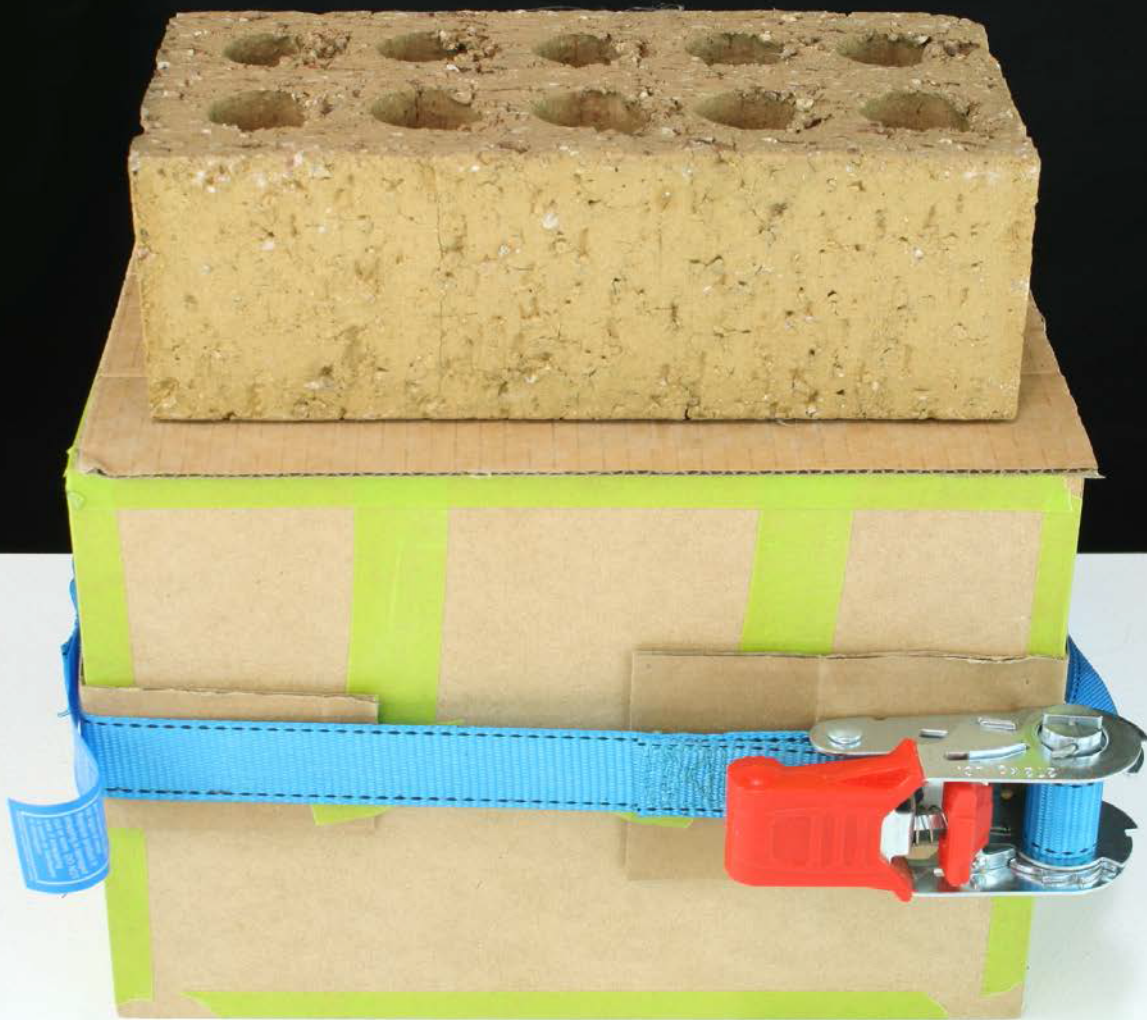

Place a cardboard protector on top of the baffle then a brick on top to apply pressure.

We don't recommend using F clamps due to the risk of forcing panels apart. The advantage of using a brick is that this avoids the temptation to use excessive force.

Drying time

Typical wood glues can achieve moderate strength in as little as 30 minutes. If you are using PVA glue then a good indicator that it has set is the transparency. PVA becomes transparent once set. Ideally it's best to leave the enclosure clamped over night before moving on to assembly or finishing.

Grille assembly

This kit uses a clever neo magnet attachment system that avoids the use of traditional grille clips. Flat packs contain neo magnets which have been concealed in the front baffle and grille.

Sequence tip

Final assembly should be done after you have applied your chosen finish. Otherwise, drivers and terminals will get damaged and the internal lining will be covered in MDF dust.

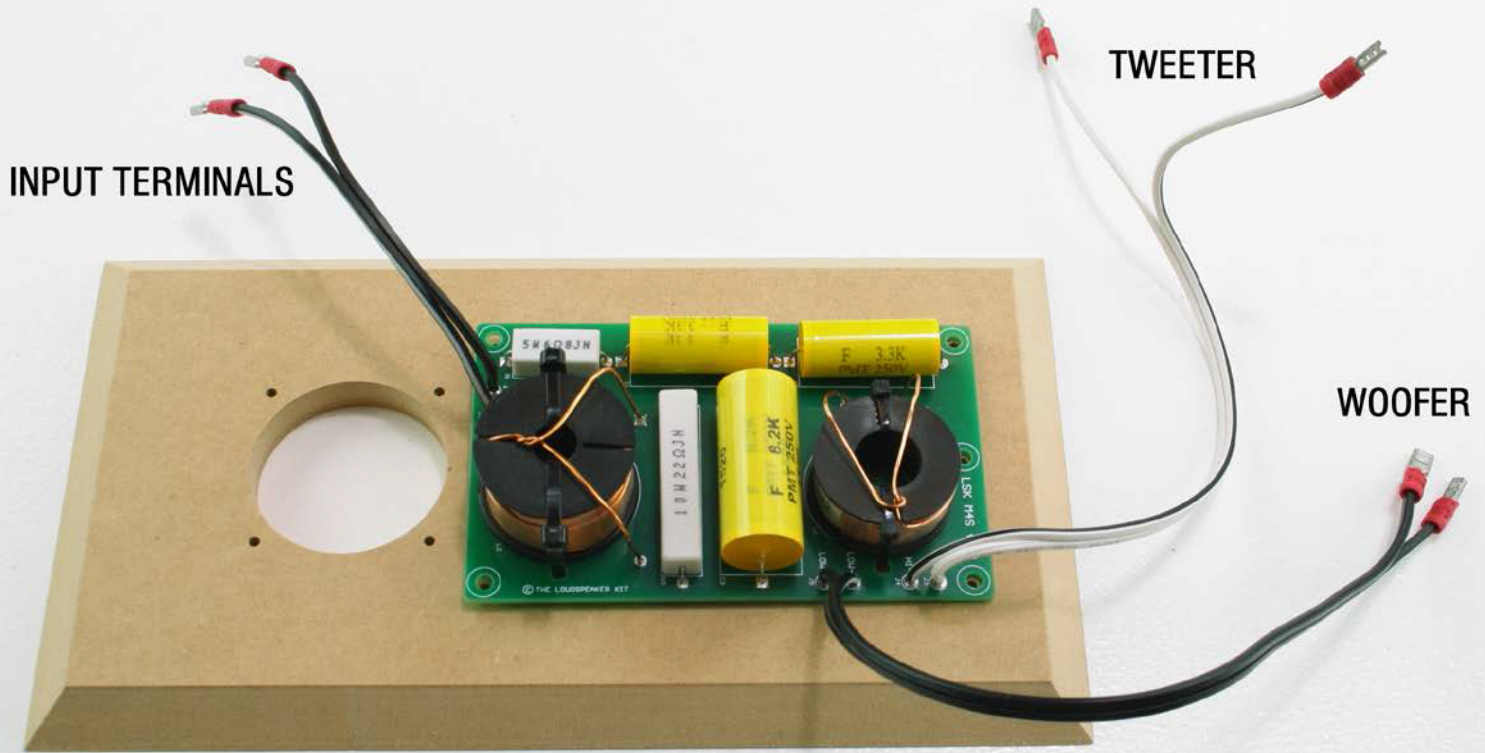

Installing the crossover board

There are three sets of cables:

- **Input terminals:** located near the larger inductor on the end of the board.
- **Tweeter output:** easily identified by the white cable
- **Woofers output:** black cable next to the tweeter outputs

The board is fixed in place with 5 short button head self tapping screws. It's best to screw them in place with a screwdriver by hand. Driver cutouts allow access as shown below.

Sequence tip: Normally this step would follow finishing the speaker. Otherwise sanding will get MDF dust over the crossover.

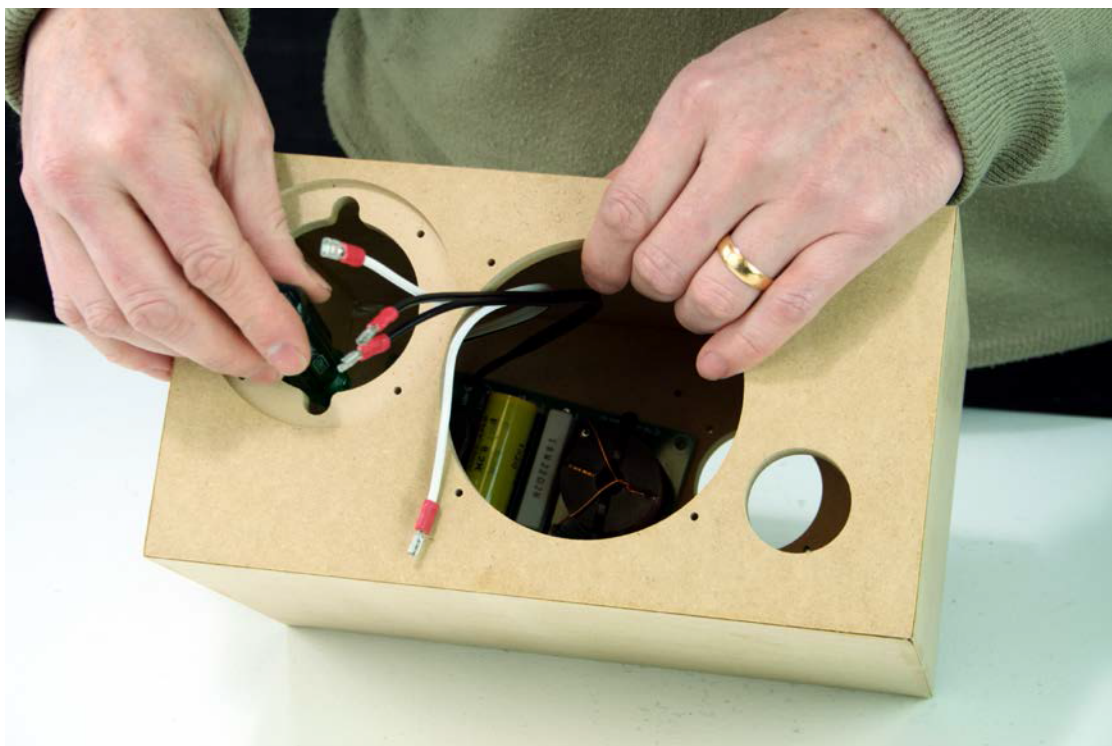

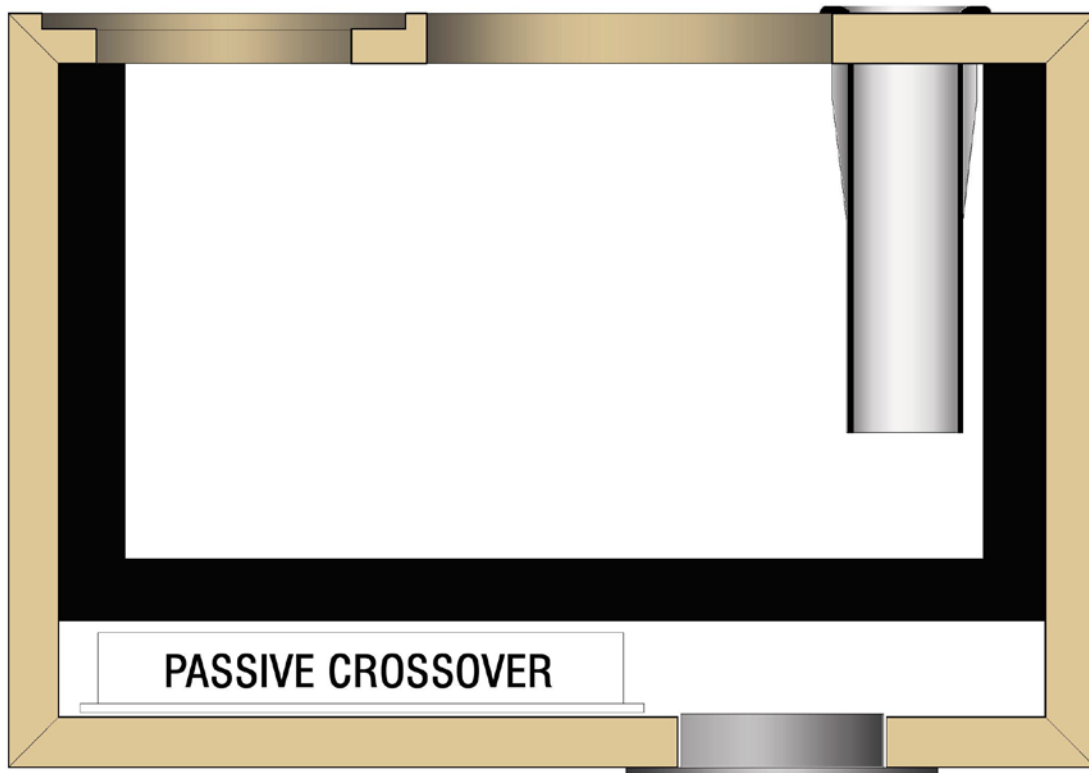

With the passive crossover in place, find the input terminals and feed them out through the rear opening. insert the black acoustic lining, which covers the rear, top and bottom internal faces of the enclosure. Check that it does not block the internal opening of the port. Glue is not necessary.

Installing terminals

Tip: It's often necessary to open out the connector slightly with a flat head screwdriver, since the fit is quite tight.

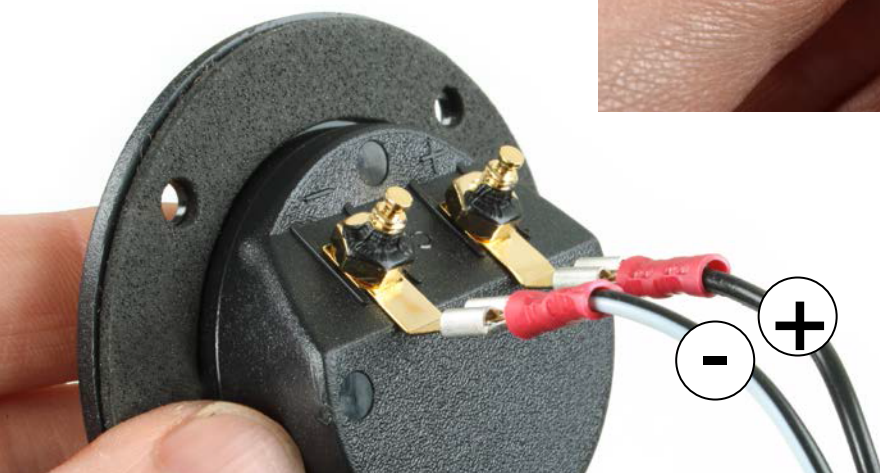

Note: The cable with the white strip goes to the negative terminal



We recommend using a Phillips head screwdriver, as some powered drivers are more likely to cause damage if the head slips off the screw head. Impact drivers should be avoided. If using a powered driver, it's best to use one which has a clutch, so that once the screws are adequately tightened, the driver will not over-tighten. This avoids stripping the MDF pre drilled holes or damage to the screw heads. If using a screwdriver, your left hand can hold the shaft to avoid slipping.

Installing drivers

Find the white wire loom for the tweeter and push the connectors onto the driver tabs.

The connectors are designed to prevent mixing up positive and negative terminals. Avoid excessive force, which can damage terminals. Lower the tweeter into its recess, aligning the terminals with the cutout slots. Then secure in place with the provided screws.

The remaining black wire loom is for the woofer. Press the connectors into place and screw the woofer in place.





Grille assembly

Lightly sand the grille frame so that the edges are slightly rounded over. This provides a more appealing effect when the grille fabric is in place. Shown below is the original grille prior to sanding and then the grille after sanding.

Painting

Although the grille frame will be covered with black cloth, it's best to paint it black to ensure the lighter colour of the raw MDF won't be seen. You can use any paint that is suitable for MDF. In this manual we show the use of a very handy paint which many DIYers use as a finish for their speaker boxes as well. It is a textured paint which can be applied direct without any priming. It can be brushed, rolled or sprayed. It's also a very fast drying paint, which allows you to move on to gluing the cloth to the frame much quicker than other options.

If you prefer to use a spray can, don't skip priming as most spray paints won't provide a very good finish when applied to raw MDF. For best results with a spray can, we suggest two prime coats and then two top coats, being careful to observe the recommended time between coats. Typically spray painting will take longer than 4 hours. By contrast, the texture paint we use allows you to start gluing on cloth in as little as 30 minutes. This can vary depending on climate.

Pre-installed neo magnets allow the grille to snap into place





Lay out the grille on a suitable covering to protect your work surface. It's a good idea to use disposable gloves for rolling the grille. The paint we use here is Acry-tech DuraTex which can be purchased through Cannon the Australian Distributor. The ideal roller has a 5mm short nap – and is small to avoid soaking up too much paint into the roller. Here we're using a sample roller. Although you can purchase a texture roller designed for Duratex, we don't recommend it for grilles as the texture is quite coarse.

Handy tip: Avoid extra clean up and paint waste by dipping the roller directly into the paint tub. You can use a scrap of cardboard as shown above to ensure the paint is even spread around the roller.

A few points to note:

- If you are painting a number of grilles at a time, start with one side for all of them. By the time you have done one side for all of them, you may be able to progress to the underside.
- Avoid applying the paint too thick – thinner application with a low nap roller provides a smoother finished result
- Texture can be improved by rolling over previously applied paint that has not yet dried – as the paint starts to become tacky the texture can be better controlled
- Two coats are ideal for grilles
- The second coat can be applied when the first is touch dry. If the first coat is thin, often the first grille will be ready for the second coat as soon as you have painted the other.



Masking

On the backside of the grille, you will notice a trench inset from the edges. This is the cut line and defines the area where the cloth will be glued to the frame. The area inside this line needs to be masked. This allows you to use spray contact adhesive, which provides flat and even coverage in addition to a fast application. You can measure and cut your own masking or download the PDF template file (print 100% scale on an A4 sheet). Or you may prefer to simply use masking tape.

A few features of our mask:

- Masking tape tabs to lift the mask after glue application
- Sticky tabs where the masking tape holds down the mask to the frame

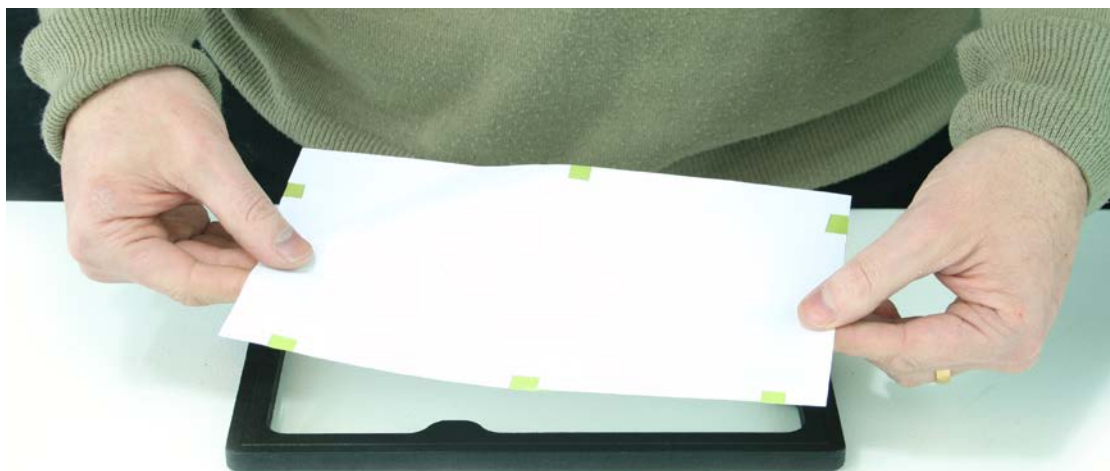



Spray contact adhesive is the simplest and quickest to use and it goes on evenly. Be sure to carefully follow the instructions on the can as each one is slightly different.

Glue is only required on the back surface as shown here – no glue is required to the sides.

Allow a suitable setting time for the glue. This is different for each product. If you attempt to attach the cloth too soon, the results may be less than ideal.

At this point, the advantage of using the mask becomes clear. You can quickly remove it with the masking tape tabs and move on to the next step, without excess glue causing problems.

Now press the cloth onto the glue on the back of the frame. Start with one side and then follow with the opposing side, stretching the cloth so that wrinkles are seen. These will be removed when the other pair of sides are glued in place.

Avoid contact of the cloth around the corners. It's important that these are done last.





Repeat with the other pair of sides. When the final end is pressed into place, all wrinkles should be removed.

Wrinkle free corners

The biggest challenge in assembling a grille is the corners. If not done correctly, these will bunch up with many wrinkles. The secret is to stretch the fabric into place.



Hold the cloth with both hands, then pull it back over the frame. Stretch it firmly, pulling back into the correct position. After stretching it into place, press down to the glue area.

If you find that you have wrinkles on first attempt, you can remove it and try again. It's important to work without interruption at this stage, as there is a limited work time involved with the adhesive.



Now you can use your thumbnail to find the cut line. Pressing your nail into the trench, score all the way around. Then with a sharp blade, slowly and carefully cut away the grille cloth, using the trench as a guide.

Tips for a better cut:

- Cut with multiple passes – avoid the temptation to try to cut all the way through in one pass
- Cut slowly and carefully, ensuring the the blade stays on track
- Cut with a shallow vertical angle – this avoids any tearing you can get if the blade is too vertical



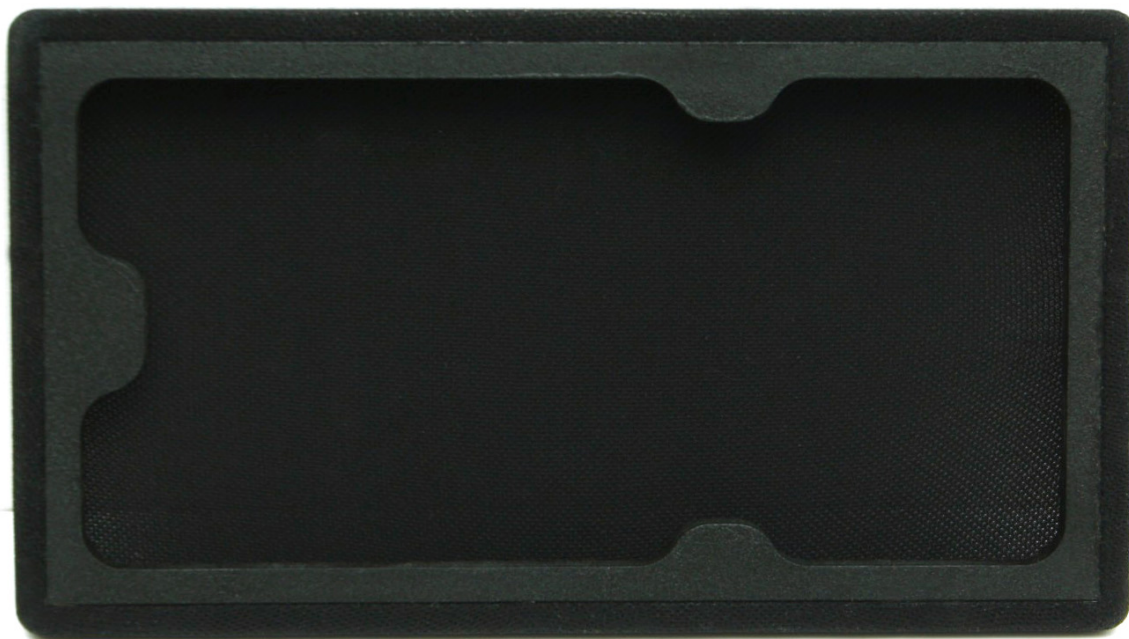

Parts List:

- 2 x 4½" SB Acoustics SB12PFC25-8 Woofers (8 Ohm)
- 2 x SB Acoustics: SB19ST-C000-4 Tweeters (4 Ohm)
- 2 x Crossover Networks XO-M4S (4KHz 18dB High pass / 12dB Low Pass)
- 2 x Round input Terminals
- 12 x Panels of CNC machined MDF featuring our unique panel locking system
- 2 x CNC machined MDF grille frame with grille cloth
- 34 x Self tapping Screws
- 2 x 25mm Tuning Ports
- 2 x Pieces of Acoustic Lining
- Grille cloth

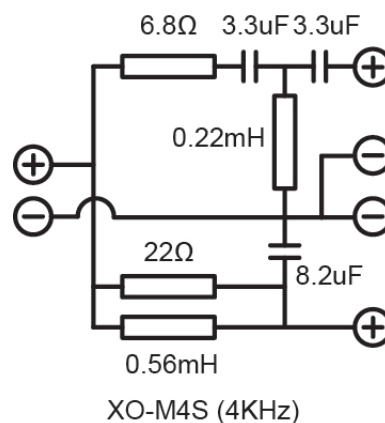

SPECIFICATIONS:

Woofer Size:	4½"
Woofer Cone:	Paper
Tweeter:	Soft dome
Frequency	Response: 65Hz (-3dB) to 20KHz, +/- 2dB
Recommended Amplifier:	50-100W RMS
Crossover:	4KHz 18dB/12dB
Sensitivity:	86 dB
Power Handling:	50W RMS, 100W peak
Impedance:	Nominal 8 ohm (minimum 6.6 ohm)
Dimensions:	260mm high x 145mm wide x 180mm deep

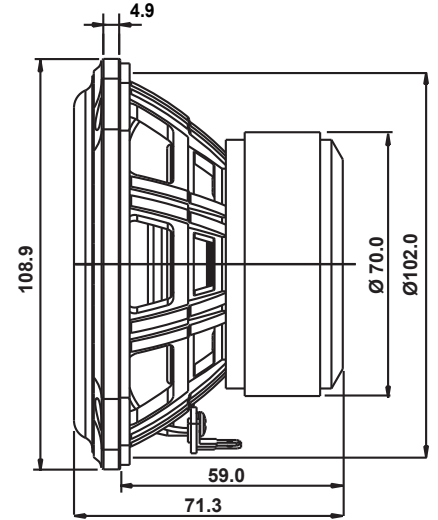
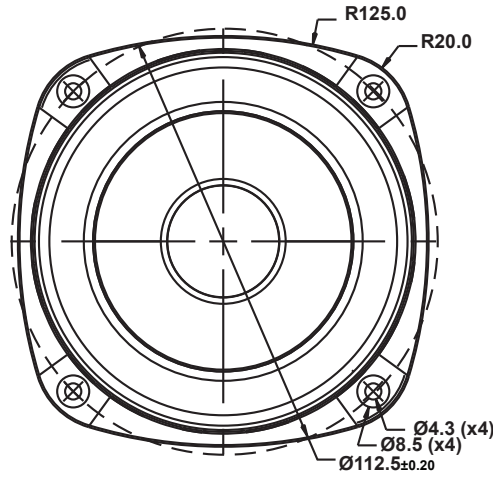

FEATURES

- Vented reinforced plastic chassis
- Proprietary cone material with natural fibers made in-house
- Butyl rubber surround for smooth frequency response
- Vented motor system for low compression
- Long stroke linear suspension for improved dynamics
- Non-resonant long life lead wires

Specs :

Nominal Impedance	8 Ω	Free air resonance, Fs	64 Hz
DC resistance, Re	6.4 Ω	Sensitivity (2.83 V / 1 m)	84.5 dB
Voice coil inductance, Le	0.36 mH	Mechanical Q-factor, Qms	4.10
Effective piston area, Sd	50 cm ²	Electrical Q-factor, Qes	0.65
Voice coil diameter	25.4 mm	Total Q-factor, Qts	0.56
Voice coil height	15 mm	Moving mass incl.air, Mms	5.1 g
Air gap height	5 mm	Force factor, Bl	4.5 Tm
Linear coil travel (p-p)	10 mm	Equivalent volume, Vas	4.3 liters
Magnetic flux density	0.84 T	Compliance, Cms	1.21 mm/N
Magnet weight	0.32 kg	Mechanical loss, Rms	0.5 kg/s
Net weight	0.7 kg	Rated power handling*	30 W

* IEC 268-5, T/S parameters measured on drive units that are broken in.

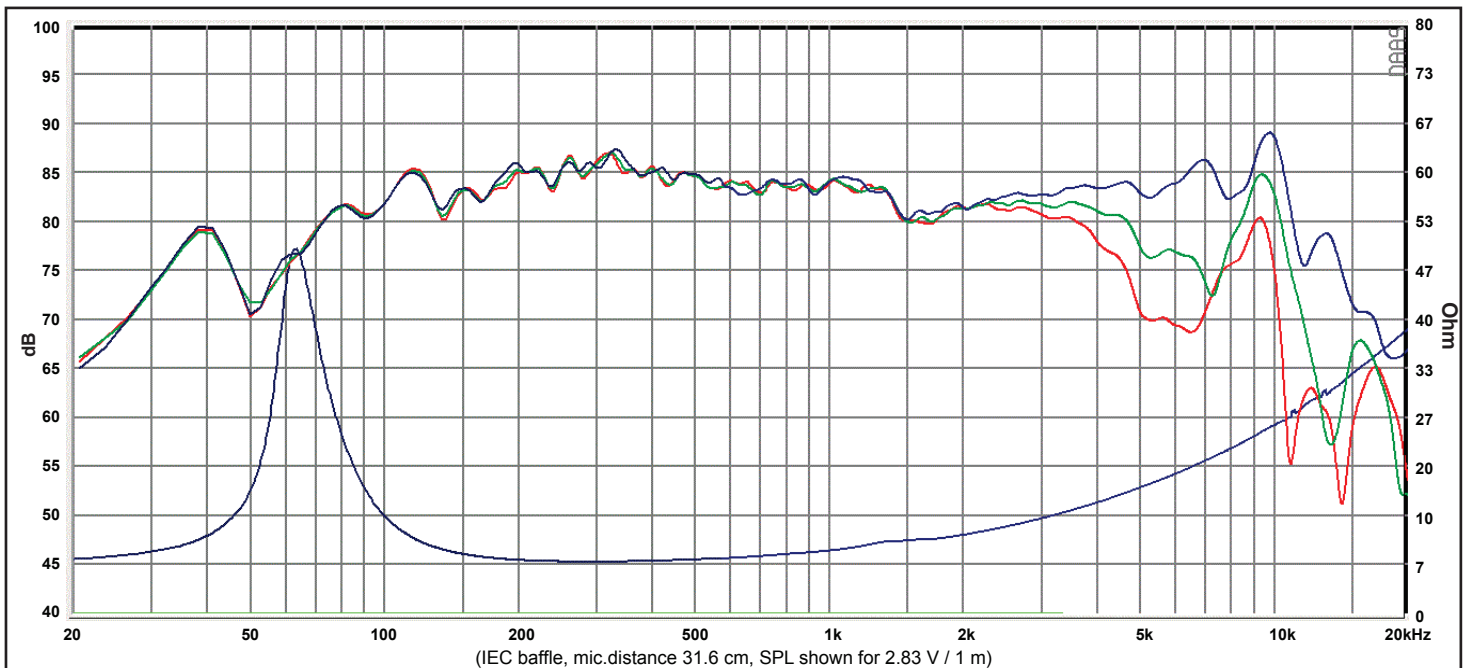

Response Curve :

— (Blue) : on axis

— (Green) : 30° off-axis

— (Red) : 60° off-axis

REV.0 (22.09.2017)

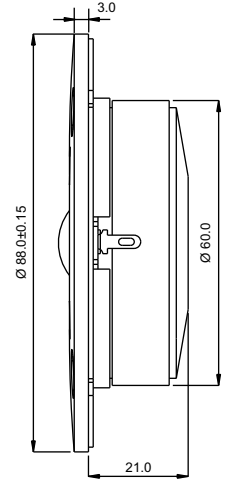
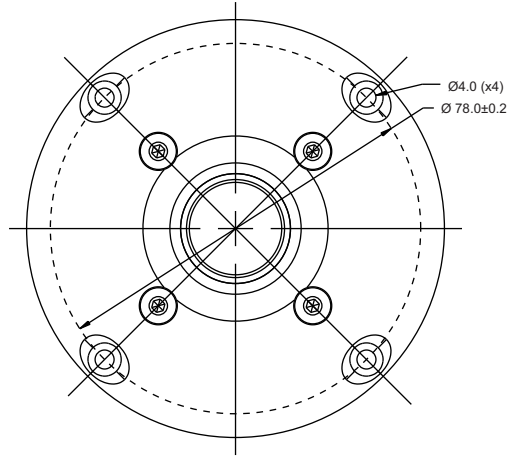

FEATURES

- Optimized damping in pole cavity to eliminate internal reflection
- Fine weave soft fabric dome for smooth frequency response
- Saturation controlled motor system for reduced distortion
- CCAW voice coil for low moving mass
- Long life silver lead wires

Specs :

Nominal Impedance	4 Ω	Free air resonance, Fs	980 Hz
DC resistance, Re	3.4 Ω	Sensitivity (2.83 V / 1 m)	88.5 dB
Voice coil inductance, Le	0.07 mH	Mechanical Q-factor, Qms	6.45
Effective piston area, Sd	3.8 cm ²	Electrical Q-factor, Qes	1.50
Voice coil diameter	19.1 mm	Total Q-factor, Qts	1.22
Voice coil height	1.8 mm	Force factor, Bl	1.75 Tm
Air gap height	3 mm	Rated power handling*	30 W
Linear coil travel (p-p)	1.2 mm	Magnetic flux density	1.24 T
Moving mass incl. air, Mms	0.22 g	Magnet weight	0.13 kg
		Net weight	0.32 kg

* IEC 268-5, high-pass Butterworth, 2600 Hz, 12 dB/oct.



Response Curve :
 — (Blue) : on axis
 — (Green) : 30° off-axis
 — (Red) : 60° off-axis

REV. 3 (11.03.2016)